

4750 – Zinc Die Cast Adjustable Handle

It made of zinc die-cast, black RAL9011. Inner parts in black Steel (UNI5105)

Female Handle

Part Number	R	H	A	B	D	d1
11-HBZA43S4	43	30	24	5	14	M4
11-HBZA43S5	43	30	24	5	14	M5
11-HBZA43S6	43	30	24	5	14	M6
11-HBZA65S6	65	45	27	7	19	M6
11-HBZA65S8	65	45	27	7	19	M8
11-HBZA80S8	80	56	33	8	22	M8
11-HBZA80S10	80	56	33	8	22	M10
11-HBZA80S12	80	56	33	8	22	M12
11-HBZA94S10	94	65	39	10	26	M10
11-HBZA94S12	94	65	39	10	26	M12
11-HBZA94S16	94	65	39	10	26	M16
11-HBZA108S16	108	77	41	12	30	M16

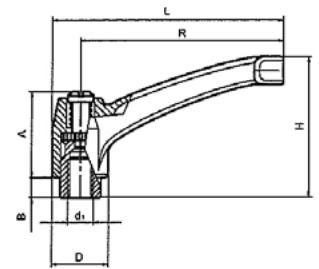

Male Handle

Part Number	R	H	A	B	D	d1	e
11-HBZA43S5-15	43	30	24	5	14	M5	15
11-HBZA43S5-30	43	30	24	5	14	M5	30
11-HBZA43S6-15	43	30	24	5	14	M6	15
11-HBZA43S6-25	43	30	24	5	14	M6	25
11-HBZA43S6-40	43	30	24	5	14	M6	40
11-HBZA65S6-20	65	30	27	7	19	M6	20
11-HBZA65S6-30	65	45	27	7	19	M6	30
11-HBZA65S8-15	65	45	27	7	19	M8	15
11-HBZA65S8-30	65	45	27	7	19	M8	30
11-HBZA65S8-45	65	45	27	7	19	M8	45
11-HBZA80S8-20	80	56	33	8	22	M8	20
11-HBZA80S8-40	80	56	33	8	22	M8	40
11-HBZA80S10-20	80	56	33	8	22	M10	20
11-HBZA80S10-40	80	56	33	8	22	M10	40
11-HBZA94S12-20	94	65	39	10	26	M12	20
11-HBZA94S12-35	94	65	39	10	26	M12	35
11-HBZA94S12-50	94	65	39	10	26	M12	50
11-HBZA94S16-30	94	65	39	10	26	M16	30
11-HBZA94S16-50	94	65	39	10	26	M16	50
11-HBZA108S16-40	108	77	41	12	30	M16	40
11-HBZA108S16-60	108	77	41	12	30	M16	60

